



**Zillion Automation**

WWW.ZHENJIZDH.COM

Precision Cycle Line R & D and  
Production Integrated Service Provider

**Zillion Automation Technology CO.,LTD.**

# GMP Series Product Manual

## PRODUCT BROCHURE

Quality first

Innovative technology

Cost advantage

# Zillion Automation Technology CO.,LTD.

Precision cycle line R & D and production integrated service provider

Zillion Technology is a technology enterprise focusing on the design, development, production and application of precision cycle lines and transmission products. We provide precision circulation conveying system for automatic production line in various industries, and provide personalized circulation conveying system design and customization, providing circulation line integrated application solutions.

## Our Advantages



### Technical Advantage

Zillion Technology's V-shaped annular guide has broken the traditional technology monopoly, established a new industry standard, and has an experienced R & D, design, and production team.



### Quality Advantage

Customized standards, a strict quality management system, product production process has multiple layers of quality control.



### Price Advantage

Source R & D enterprises, own factories, to ensure high quality under the premise of lower costs, more favorable prices.



### Delivery Advantage

Achieve standardization, own standard inventory, warehouse area of 300 square meters, conventional product delivery within 12 days.



### Advantage of Service

With experienced project design team, timely technical support in most areas, excellent service.

## GMP Product Display

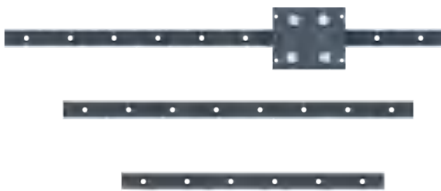

Linear guideway and slide seat



Circular guideway



Dear guide

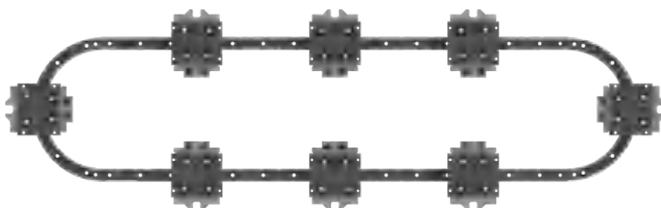

Oval guideway

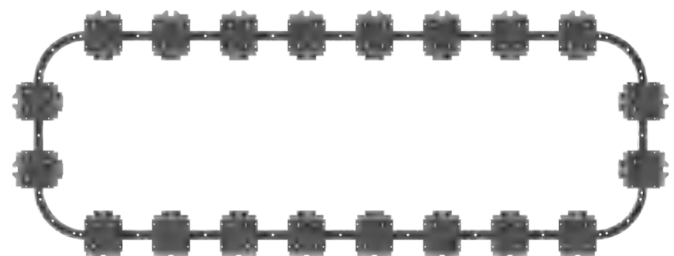

Rectangular guideway

# CONTENTS

<b>P1—About Zillion Technology</b>
<b>P3—The Core Parts Of GMP Series Products</b>
<b>P5—25 Series Of GMP Products</b>
TO25 360°Guideway
HC25 180°Guideway
RB25 90°Guideway
SR25 Linear Guideway
25 Series Guideway Modules
<b>P10—44 Series Of GMP Products</b>
TO44 360°Guideway
HC44 180°Guideway
RB44 90°Guideway
SR44 Linear Guideway
44 Series Guideway Modules
<b>P15—76 Series Of GMP Products</b>
TO76 360°Guideway
HC76 180°Guideway
RB76 90°Guideway
SR76 Linear Guideway
76 Series Guideway Modules
<b>P20—Gear Guideway Of GMP Products</b>
25 Series Gear Guideway
44 Series Gear Guideway
76 Series Gear Guideway
<b>Application Cases Of GMP Series Products</b>

# GMP Series Products

## Core Component

The core components of **V-shaped guideway**, **linear guideway**, **Circular guideway**, **slide seat** and **Rack guideway** used by Zillion Technology are independently developed, designed and produced. These parts through continuous technical iteration and upgrade optimization, with high hardness, high precision, good stability, wear resistance Long service life, good compatibility and so on.

Buy our **GMP** series products, convenient to assemble precision circular guide rail circulation conveyor line, to achieve low cost, fast production application.

### Linear guideway and Slide seat

There are three main standards for the cross section of the linear guideway, which are: 25mm, 44mm and 76mm; Three different standards meet the needs of light, medium and heavy load applications. Three different standards of guideway are matched with different loads of slide seats.



### Circular guideway

There are three main standards for the cross section of the Circular guideway, which are: 25mm, 44mm and 76mm; Commonly used angles are 90°, 180°, 360°, etc.

The diameter between 200mm-1560mm is the standard product, can accept the full circle customization, please refer to the standard selection table for specific size standards.



### Gear guideway

Gear guideway is mainly split type. It has the advantages of high precision, low noise, high stability, easy installation and easy maintenance. Custom sizes between 200-1560mm in diameter are accepted, please refer to the standard selection table for specific size standards.



# GMP Series Products

## V-Shaped Guideway Parts Code

V-shaped guideway series products, in order to match the Precision loop line conveying system, improve customization efficiency, reduce manufacturing costs, formed a part of the general Standard parts products, model parameters are numerous, parts code rules are as follows:

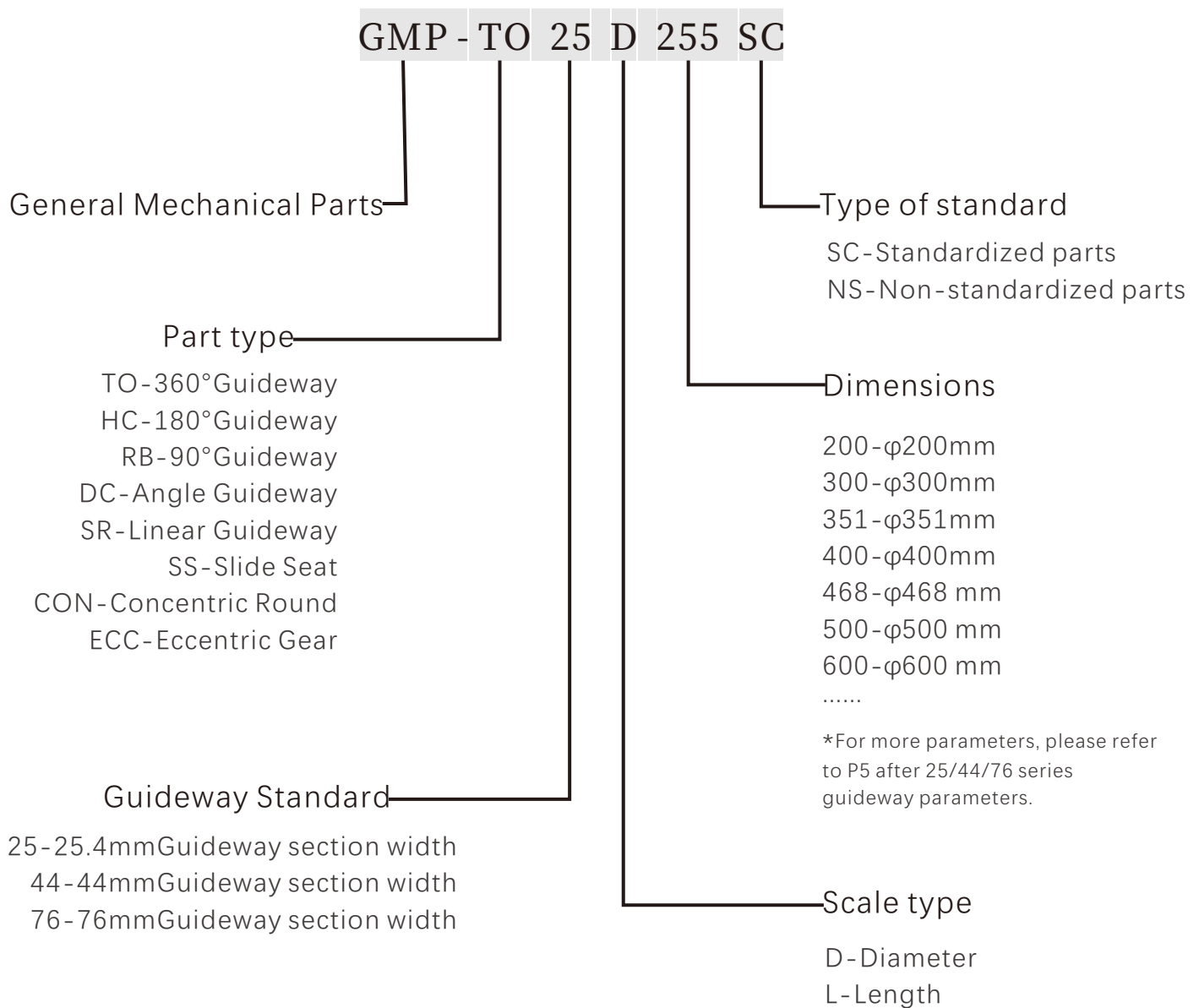

# GMP Series Products

## 25 Series-360°Circular guideway TO25



25 series V Guideway series products, belong to the light load guideway, its circular guideway, Linear guideway and other shapes, high precision, long service life.

### Surface hardness of the Guideway surface:

HRC55-58

### Designed weight:

≤ 15 kg

### Theoretical weight:

< 50 kg

### Surface plane accuracy\*:

±0.01mm

\*When the size is larger, there is the possibility of deformation, and this accuracy is related to the accuracy of the guideway mounting plane during use.

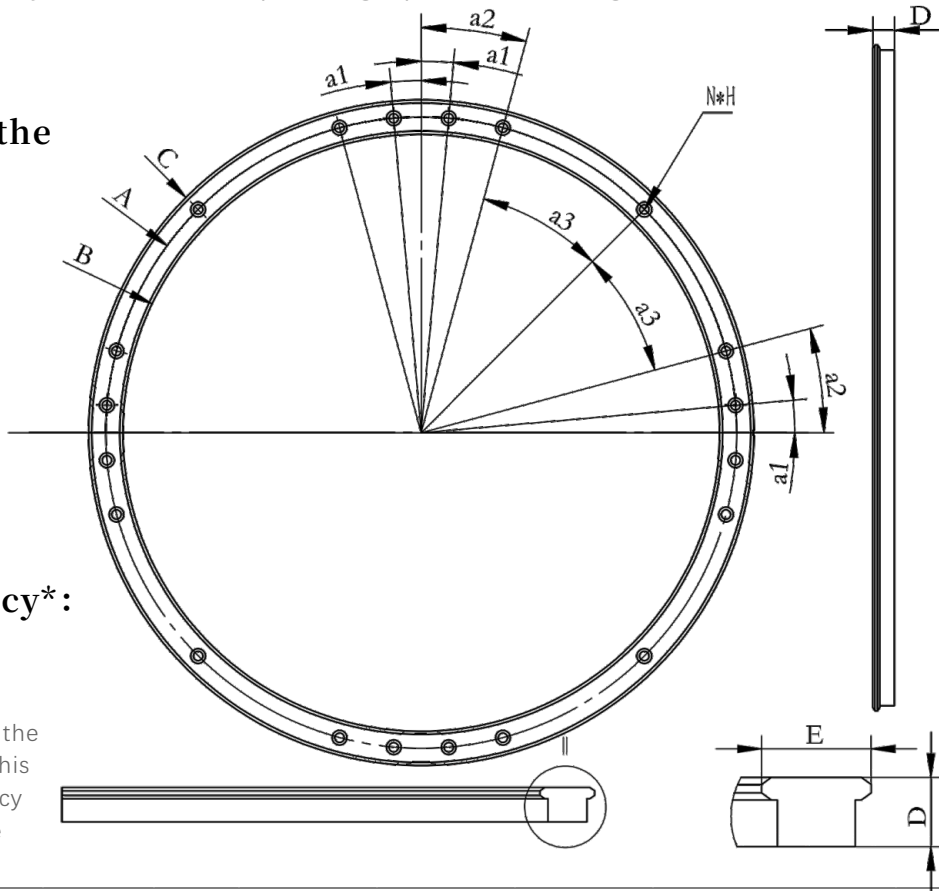

Model	Basic Size (mm)								
	φA	φB	φC	D	a1/Angle	a2/Angle	a3/Angle	N*H(Counterbore)	E
TO25D200	200	174.6	225.4	16	7	15	30	20*M6	25.4
TO25D255	255	229.6	280.4		7	15	30	20*M6	
TO25D300	300	274.6	325.4		7	15	30	20*M6	
TO25D351	351	325.6	376.4		6	15	30	20*M6	
TO25D400	400	374.6	425.4		6	15	30	20*M6	
TO25D468	468	442.6	493.4		5	15	30	20*M6	
TO25D500	500	474.6	525.4		5	15	30	20*M6	
TO25D600	600	574.6	625.4		5	11.25	22.5	24*M8	
TO25D700	700	674.6	725.4		3	11.25	22.5	24*M8	
TO25D800	800	774.6	825.4		3	9	18	28*M8	
TO25D900	900	874.6	925.4		3	9	18	28*M8	
TO25D1000	1000	974.6	1025.4		3	9	18	28*M8	

Note: The module of the gear can be customized, and the teeth of the gear can also be designed into internal teeth or external teeth according to the needs, please contact us for specific needs.

# GMP Series Products

## 25 Series-180°Circular guideway HC25

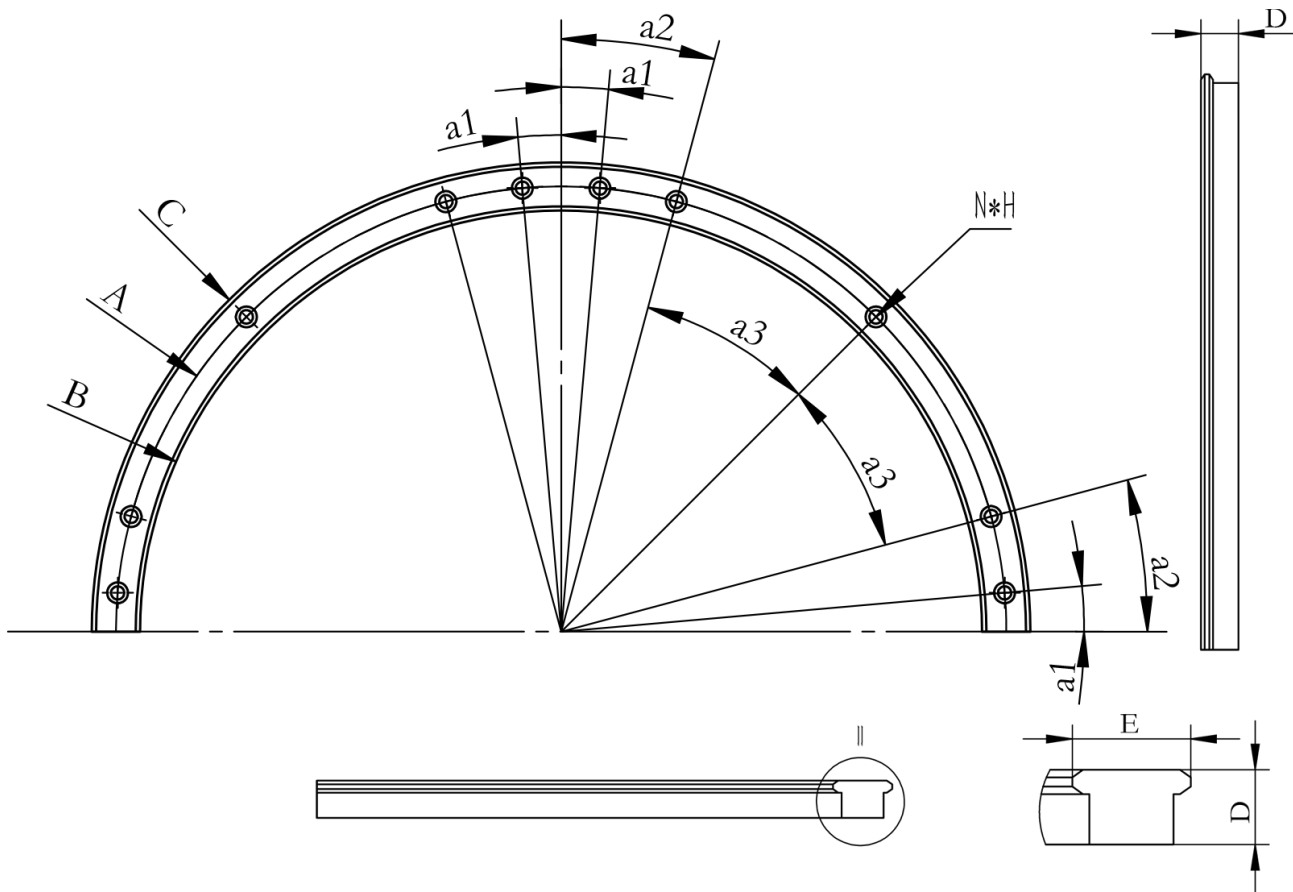

Model	Basic Size (mm)								
	$\phi A$	$\phi B$	$\phi C$	D	a1/Angle	a2/Angle	a3/Angle	N*H(Counterbore)	E
HC25D200	200	174.6	225.4	16	7	15	30	10*M6	25.4
HC25D255	255	229.6	280.4		7	15	30	10*M6	
HC25D300	300	274.6	325.4		7	15	30	10*M6	
HC25D351	351	325.6	376.4		6	15	30	10*M6	
HC25D400	400	374.6	425.4		6	15	30	10*M6	
HC25D468	468	442.6	493.4		5	15	30	10*M6	
HC25D500	500	474.6	525.4		5	15	30	10*M6	
HC25D600	600	574.6	625.4		5	11.25	22.5	12*M8	
HC25D700	700	674.6	725.4		3	11.25	22.5	12*M8	
HC25D800	800	774.6	825.4		3	9	18	14*M8	
HC25D900	900	874.6	925.4		3	9	18	14*M8	
HC25D1000	1000	974.6	1025.4		3	9	18	14*M8	

Note: The above are circular guideway of conventional standard size, among which D255-D600 are regular inventory products, and other sizes can be customized according to customer needs.

# GMP Series Products

## 25 Series-90°Circular guideway RB25

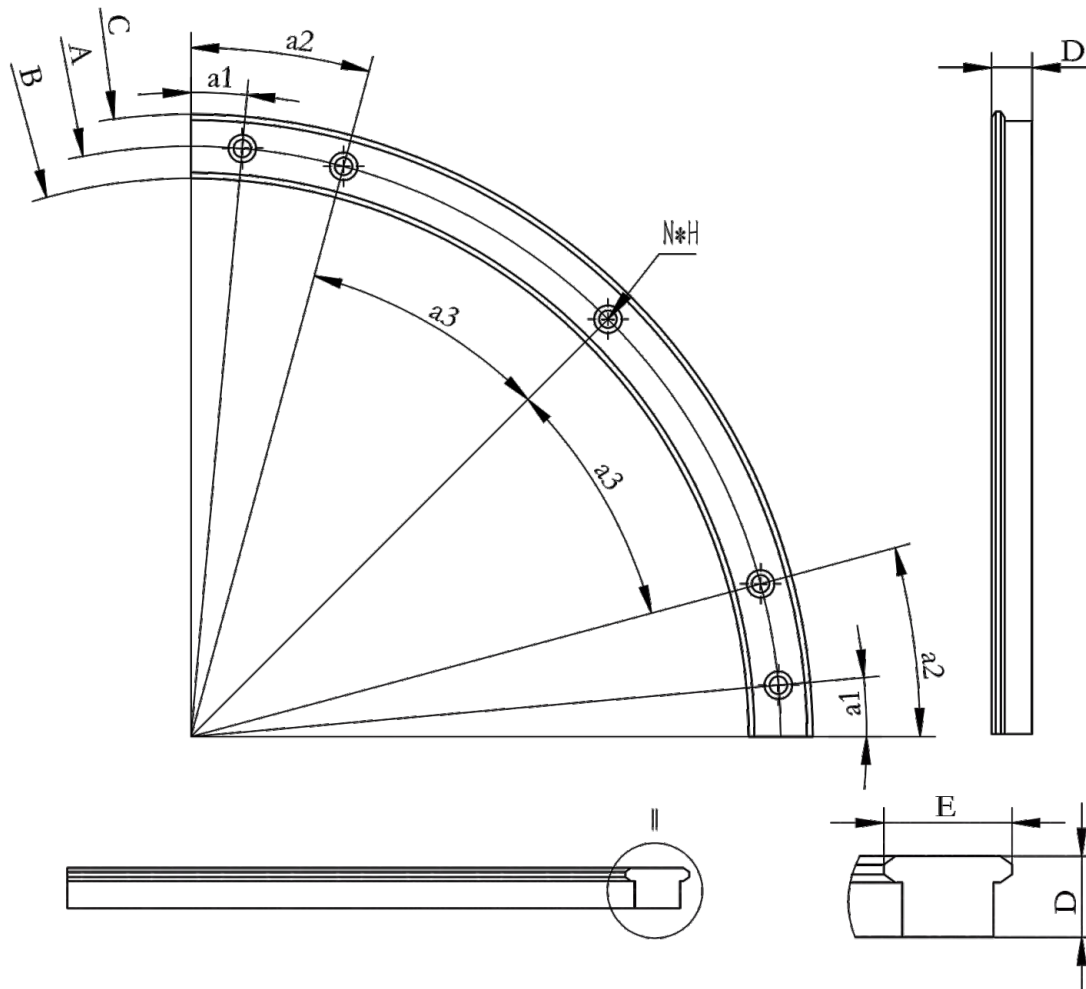

Model	Basic Size (mm)								
	$\phi A$	$\phi B$	$\phi C$	D	a1/Angle	a2/Angle	a3/Angle	N*H(Counterbore)	E
RB25D200	200	174.6	225.4	16	7	15	30	5*M6	25.4
RB25D255	255	229.6	280.4		7	15	30	5*M6	
RB25D300	300	274.6	325.4		7	15	30	5*M6	
RB25D351	351	325.6	376.4		6	15	30	5*M6	
RB25D400	400	374.6	425.4		6	15	30	5*M6	
RB25D468	468	442.6	493.4		5	15	30	5*M6	
RB25D500	500	474.6	525.4		5	15	30	5*M6	
RB25D600	600	574.6	625.4		5	11.25	22.5	6*M8	
RB25D700	700	674.6	725.4		3	11.25	22.5	6*M8	
RB25D800	800	774.6	825.4		3	9	18	7*M8	
RB25D900	900	874.6	925.4		3	9	18	7*M8	
RB25D1000	1000	974.6	1025.4		3	9	18	7*M8	

Note: The above are circular guideway of conventional standard size, among which D255-D600 are regular inventory products, and other sizes can be customized according to customer needs.



# GMP Series Products

## 25 Series- Linear guideway SR25-L2000-SS25

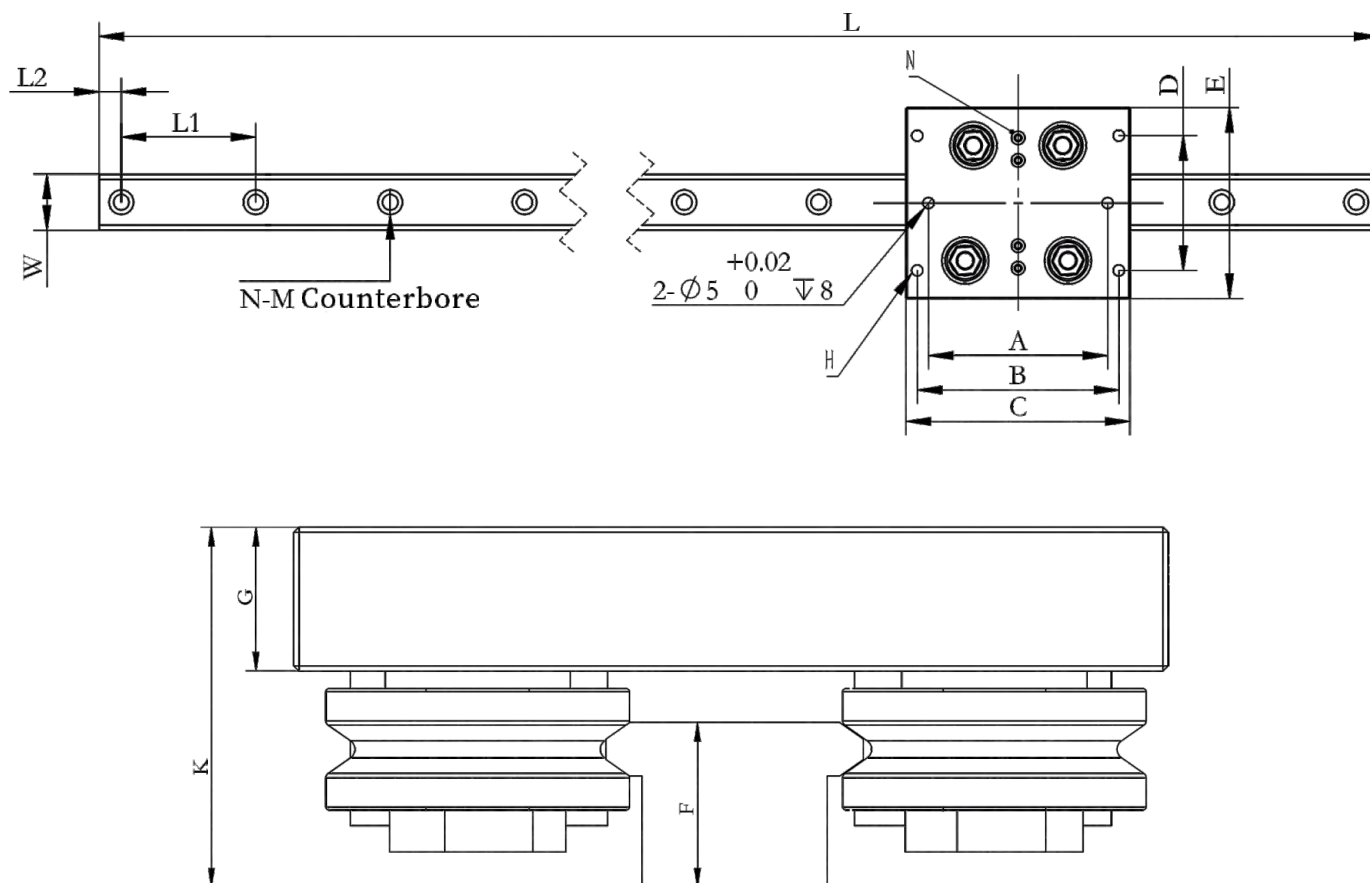

Series	Model	Basic Size (mm)													
		L	L1	L2	W	N-M Counterbore	A	B	C	D	E	F	G	K	4×H
GMP	SR25L2000SS25	≤2000	60	≤52	25.4	M6	80	90	100	60	85	16	14	35	M6

Note: The above parameters are the dimensions of our single standard linear guideway, and the length can be cut and spliced according to the requirements. Where N is the installation hole of the oil box used for lubrication and cleaning, one group for every 10 slide seats.

If  $L2 \geq 30\text{mm}$ , an additional mounting countersunk hole is added to the end.

The customized length of a single Linear guideway is:

$$L = L2 \times 2 + (n-1) \times 60 \text{ (mm)}$$

# GMP Series Products

## 25 Series- shaped guideway

### Oval guideway

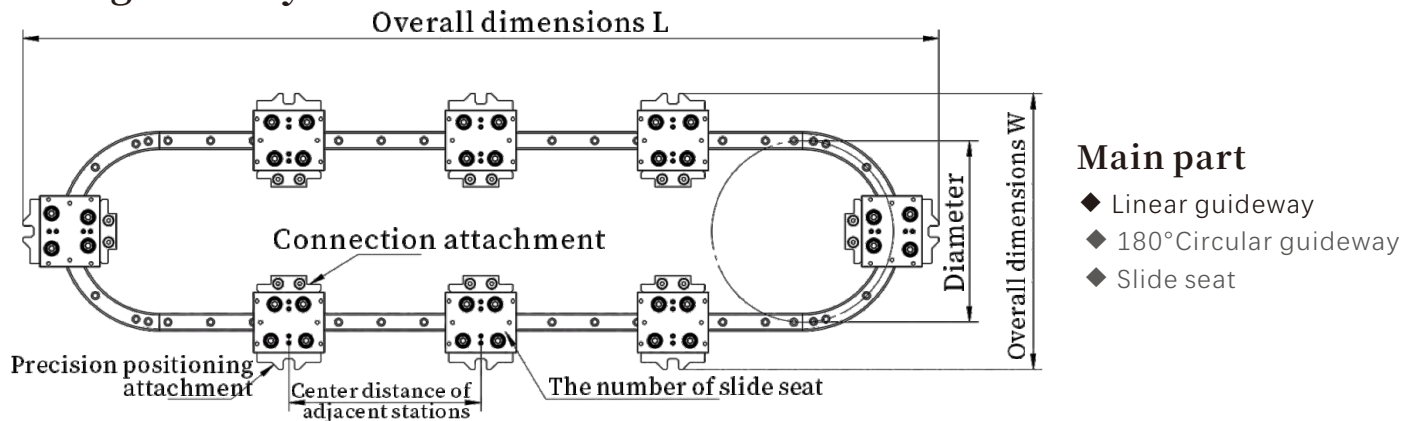

\*Non-standard customization, the linear guideway part can be cut or spliced according to needs; The 180°circular guideway size can refer to HC25 series; The number of slide seat is usually an even number.

\*Precision positioning attachment and Connection attachment are optional parts.

### Rectangular guideway

#### Main part

- ◆ Linear guideway
- ◆ 90°Circular guideway
- ◆ Slide seat

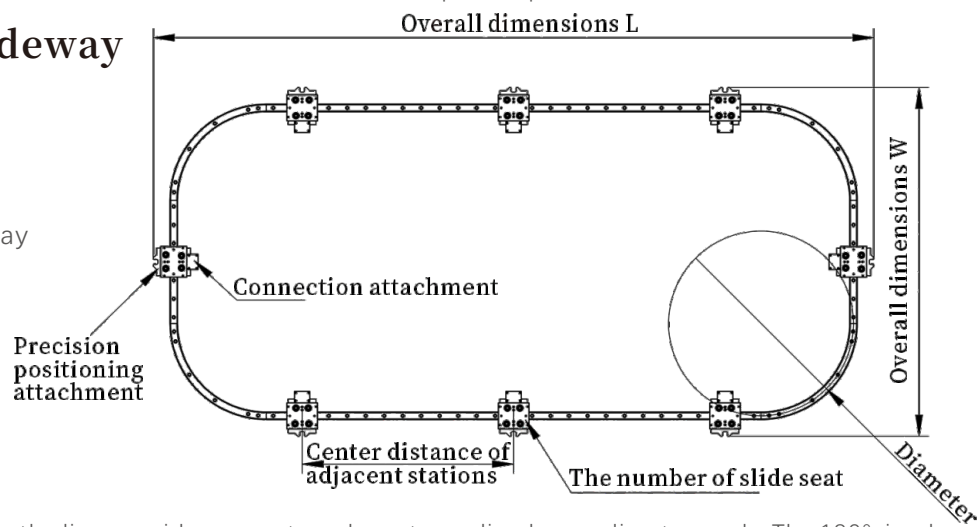

\*Non-standard customization, the linear guideway part can be cut or spliced according to needs; The 180°circular guideway size can refer to HC25 series; The number of slide seat is usually an even number.

\*Precision positioning attachment and Connection attachment are optional parts.

### Other shapes guideway

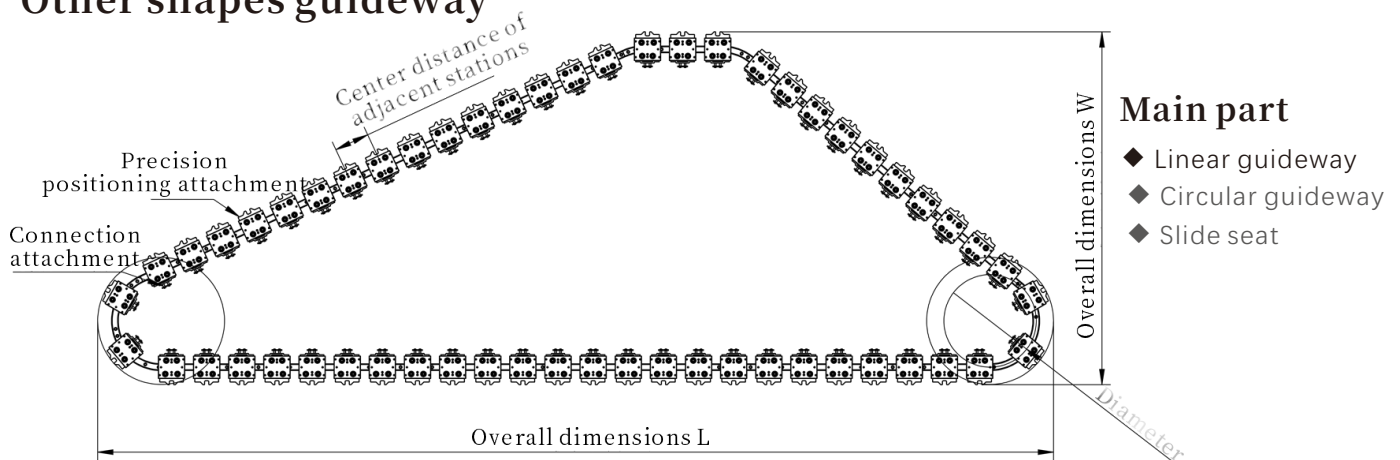

\* Non-standard customization, the linear guideway part can be cut or spliced according to needs; The circular guideway size can refer to HC25 series;

\* Precision positioning attachment and Connection attachment are optional parts.

# GMP Series Products

## 44 Series-360°Circular guideway TO44



44 series V Guideway series products, belong to the medium load guideway, its circular guideway, Linear guideway and other shapes, high precision, long service life.

### Surface hardness of the Guideway surface:

HRC55-58

### Designed weight:

$\leq 30 \text{ kg}$

### Theoretical weight:

$< 100 \text{ kg}$

### Surface plane accuracy\*:

$\pm 0.01 \text{ mm}$

\*When the size is larger, there is the possibility of deformation, and this accuracy is related to the accuracy of the guideway mounting plane during use.

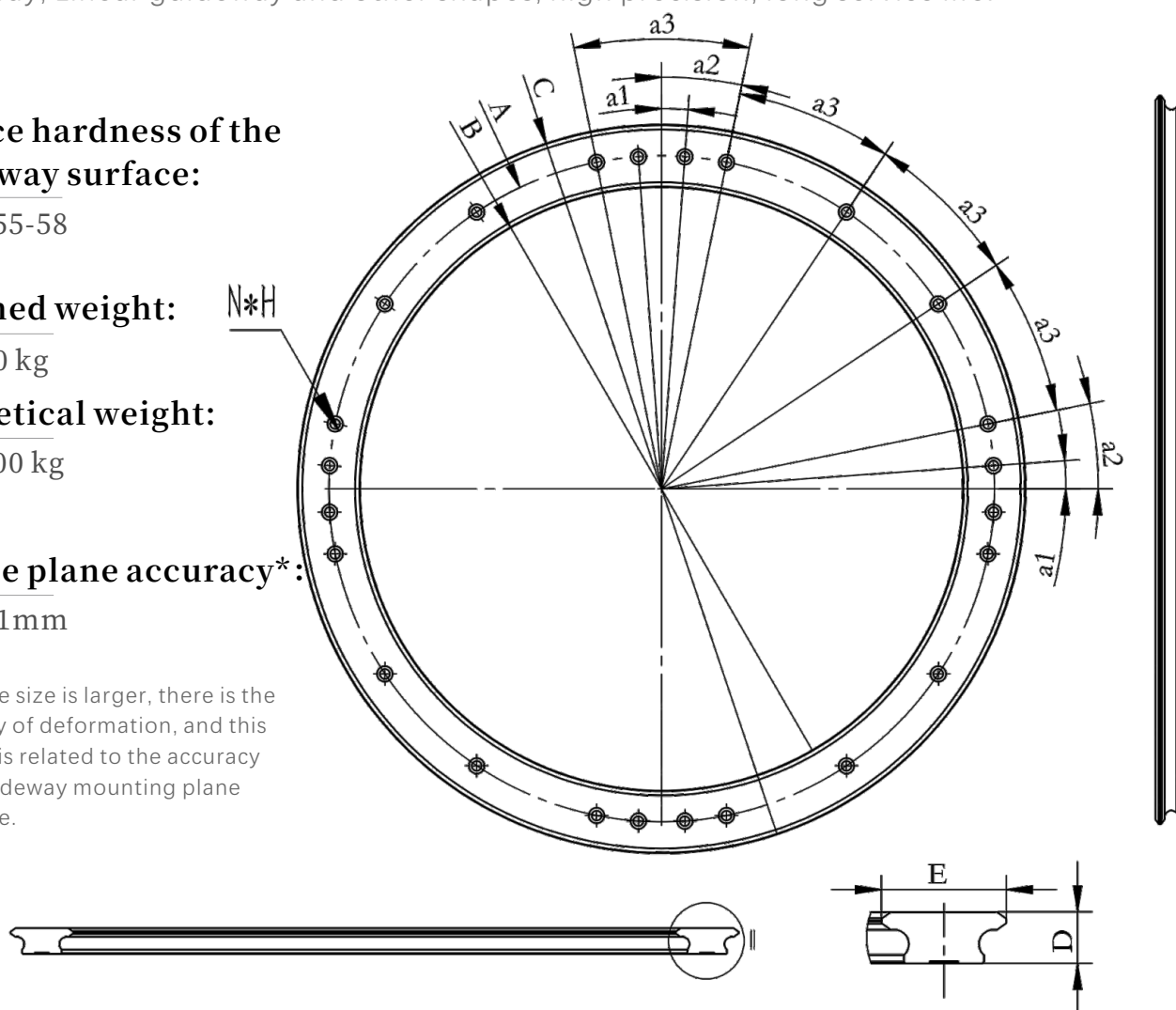

Model	Basic Size (mm)								
	φA	φB	φC	D	a1/Angle	a2/Angle	a3/Angle	N*H(Counterbore)	E
TO44D468	468	424	512	18	4	11.25	22.5	24*M6	44
TO44D612	612	568	656		4	11.25	22.5	24*M6	
TO44D800	800	756	844		4	11.25	22.5	24*M6	
TO44D1000	1000	956	1044		3	9	18	28*M8	

Note: According to customer needs, the whole circular guideway can be cut into different angles, so that it can be used alone or for gear combination or linear guideway combination, form a closed-loop or open-loop annular guide system.

The above are circular guideway of conventional standard size, and other sizes can be customized according to customer needs.

# GMP Series Products

## 44 Series-180°Circular guideway HC44

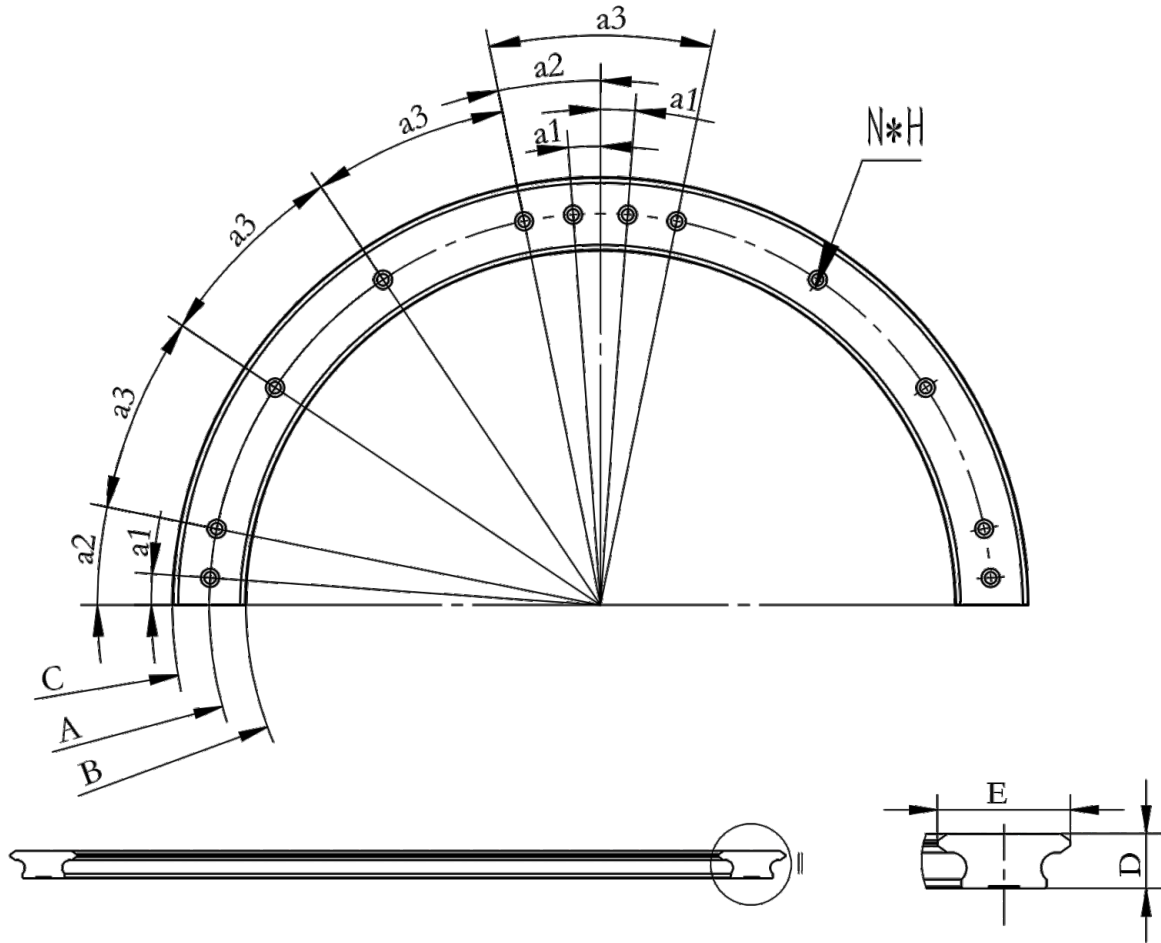

Model	Basic Size (mm)								
	$\phi A$	$\phi B$	$\phi C$	D	a1/Angle	a2/Angle	a3/Angle	N*H(Counterbore)	E
HC44D468	468	424	512	18	4	11.25	22.5	12*M6	44
HC44D612	612	568	656		4	11.25	22.5	12*M6	
HC44D800	800	756	844		4	11.25	22.5	12*M6	
HC44D1000	1000	956	1044		3	9	18	14*M8	

Note: The above are circular guideway of conventional standard size, and other sizes can be customized according to customer needs.

# GMP Series Products

## 44 Series-90°Circular guideway RB44

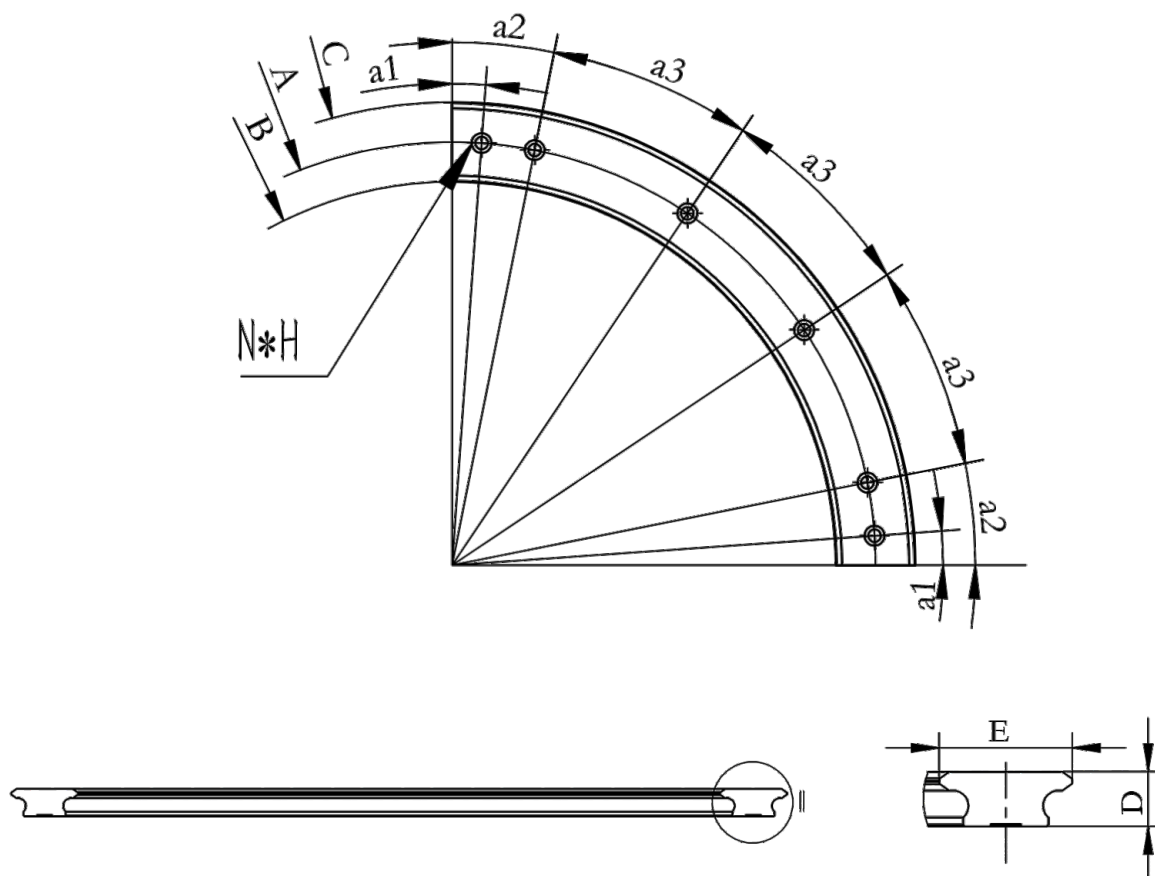

Model	Basic Size (mm)								
	φA	φB	φC	D	a1/Angle	a2/Angle	a3/Angle	N*H(Counterbore)	E
RB44D468	468	424	512	18	4	11.25	22.5	6*M6	44
RB44D612	612	568	656		4	11.25	22.5	6*M6	
RB44D800	800	756	844		4	11.25	22.5	6*M6	
RB44D1000	1000	956	1044		3	9	18	7*M8	

Note: The above are circular guideway of conventional standard size, and other sizes can be customized according to customer needs.

# GMP Series Products

## 44 Series- Linear guideway SR44-L2000-SS44

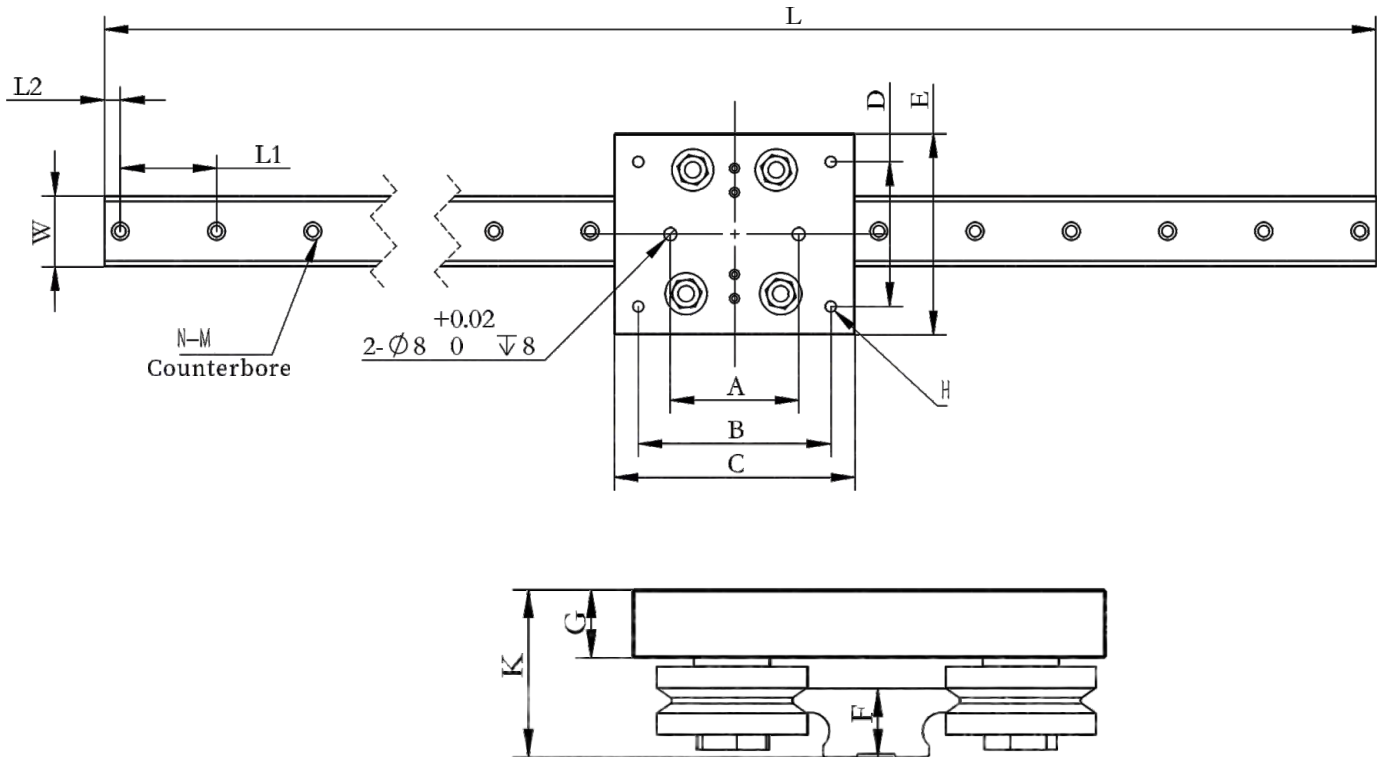
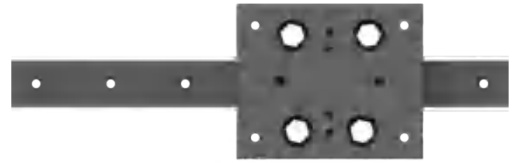

Series	Model	Basic Size (mm)													
		L	L1	L2	W	N-M Counterbore	A	B	C	D	E	F	G	K	4×H
GMP	SR44L2000SS44	≤2000	60	≤52	44	M6	80	120	150	90	125	18	18	44	M8

### Note:

The above parameters are the dimensions of our single standard linear guideway, and the length can be cut and spliced according to the requirements.

Where N is the installation hole of the oil box used for lubrication and cleaning, one group for every 10 slide seats.

If  $L2 \geq 30\text{mm}$ , an additional mounting countersunk hole is added to the end.

The customized length of a single Linear guideway is:

$$L = L2 \times 2 + (n-1) \times 60 (\text{mm})$$

# GMP Series Products

## 44 Series- shaped guideway

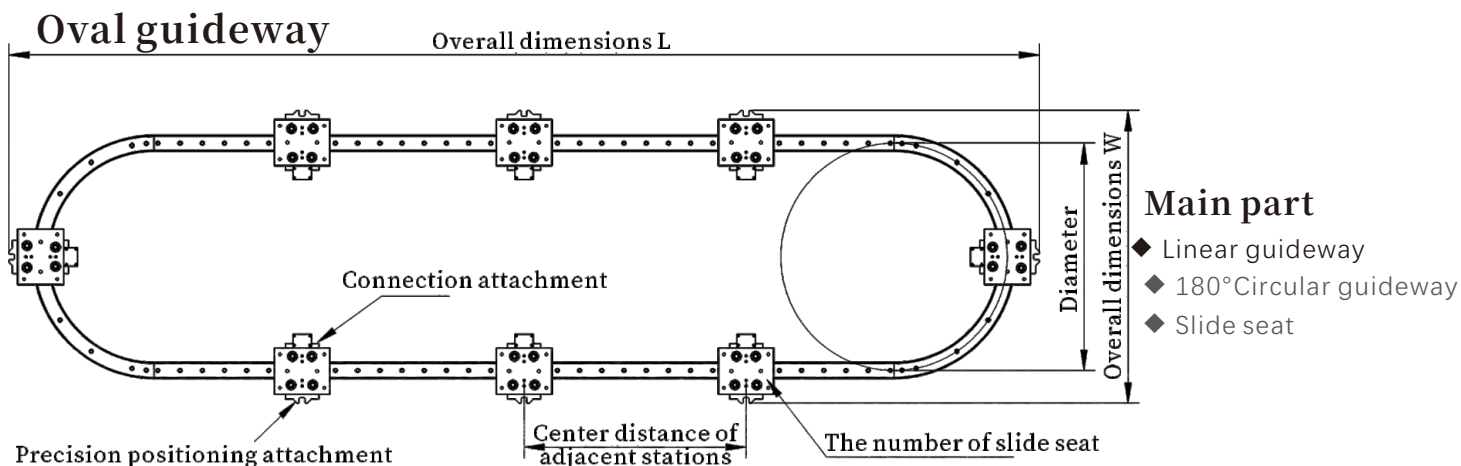

\*Non-standard customization, the linear guideway part can be cut or spliced according to needs; The 180° circular guideway size can refer to HC44 series; The number of slide seat is usually an even number.

\*Precision positioning attachment and Connection attachment are optional parts.

### Rectangular guideway

#### Main part

- ◆ Main part
- ◆ 90° Circular guideway
- ◆ Slide seat

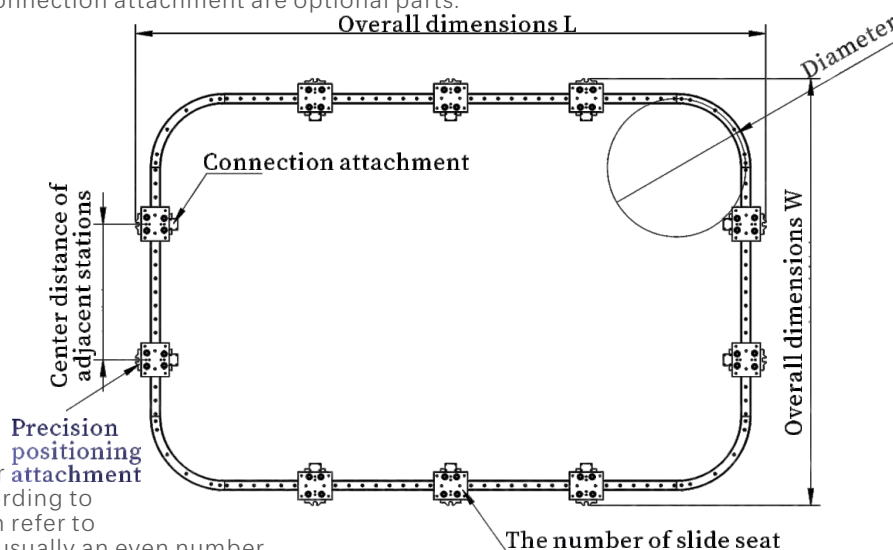

\*Non-standard customization, the linear guideway part can be cut or spliced according to needs; The 90° circular guideway size can refer to HC44 series; The number of slide seat is usually an even number.

\*Precision positioning attachment and Connection attachment are optional parts.

### Other shapes guideway

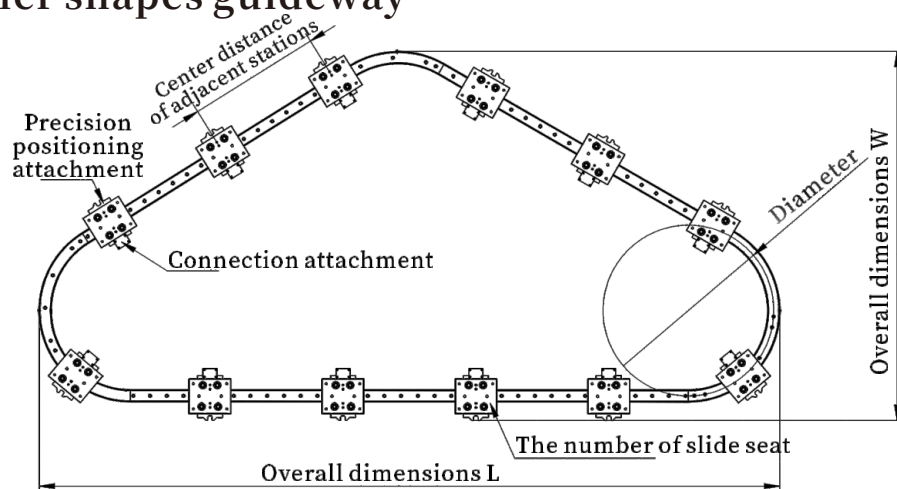

#### Main part

- ◆ Linear guideway
- ◆ Circular guideway
- ◆ Slide seat

\*Non-standard customization, the linear guideway part can be cut or spliced according to needs; The circular guideway size can refer to HC44 series; Precision positioning attachment and Connection attachment are optional parts.



# GMP Series Products

## 76 Series-360°Circular guideway TO76



76 series V Guideway series products, belong to the heavy load guideway, its circular guideway, Linear guideway and other shapes, high precision, long service life.

### Surface hardness of the Guideway surface:

HRC55-58

### Designed weight:

≤ 50 kg

### Theoretical weight:

< 150 kg

### Surface plane accuracy\*:

±0.01mm

\*When the size is larger, there is the possibility of deformation, and this accuracy is related to the accuracy of the guideway mounting plane during use.

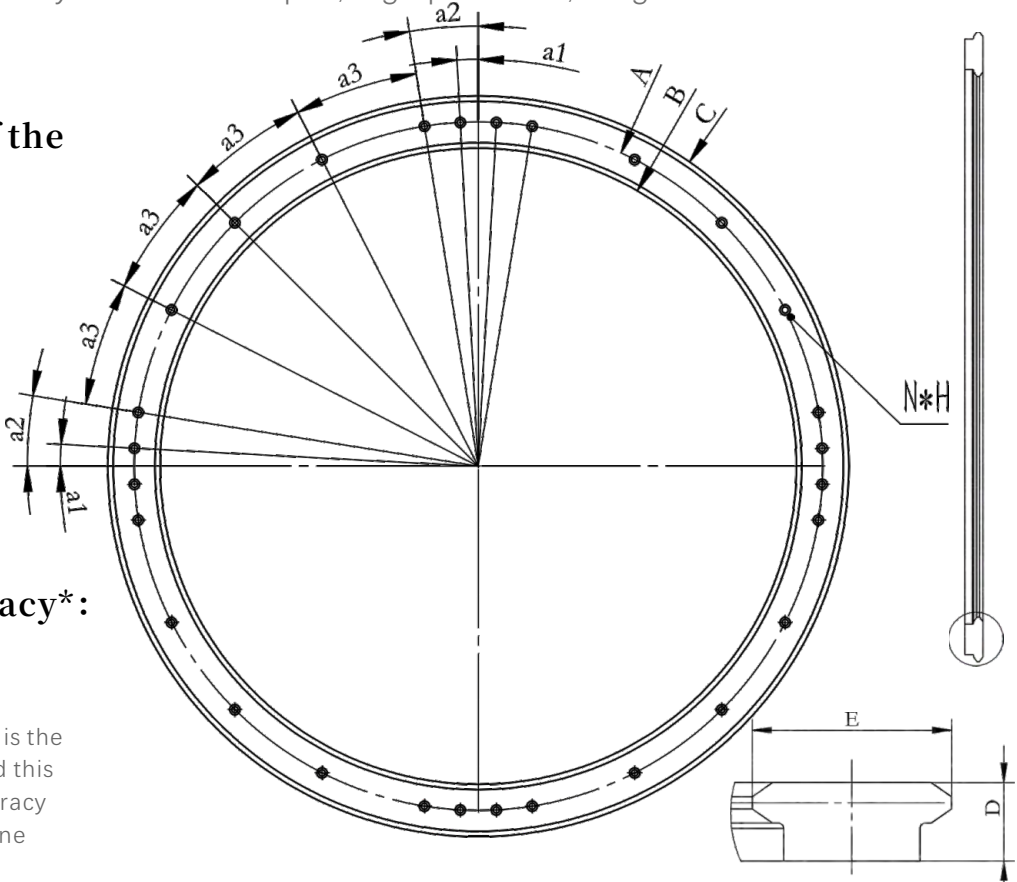

Model	Basic Size (mm)								
	φA	φB	φC	D	a1/Angle	a2/Angle	a3/Angle	N*H(Counterbore)	E
TO76D500	500	424	576	30	5	10	30	20*M8	76
TO76D700	700	624	776		3	9	18	24*M8	
TO76D900	900	824	976		3	9	18	28*M8	
TO76D1000	1000	924	1076		3	9	18	28*M8	
TO76D1100	1100	1024	1176		3	9	18	28*M8	
TO76D1200	1200	1124	1276		3	9	18	28*M8	
TO76D1267	1267	1191	1343		3	9	18	28*M8	
TO76D1300	1300	1224	1376		3	9	18	28*M8	
TO76D1400	1400	1324	1476		3	9	18	28*M8	
TO76D1500	1500	1424	1576		3	9	18	28*M8	
TO76D1560	1560	1484	1636		3	9	18	28*M8	

Note: According to customer needs, the whole circular guideway can be cut into different angles, so that it can be used alone or for gear combination or linear guideway combination, form a closed-loop or open-loop annular guide system. The above are circular guideway of conventional standard size, and other sizes can be customized according to customer needs.



# GMP Series Products

## 76 Series-180°Circular guideway HC76

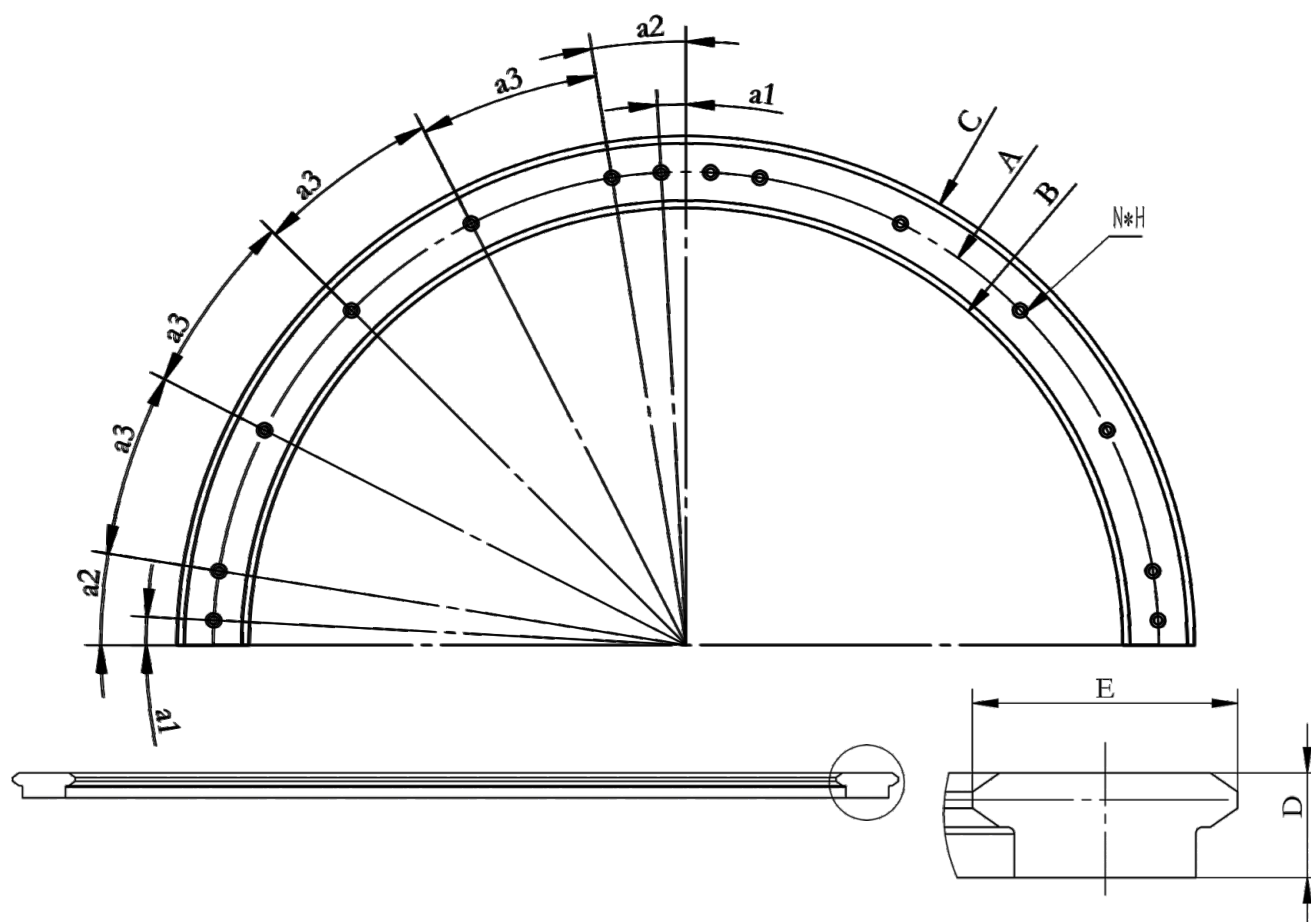

Model	Basic Size (mm)								
	$\phi A$	$\phi B$	$\phi C$	D	a1/Angle	a2/Angle	a3/Angle	N*H(Counterbore)	E
HC76D500	500	424	576	30	5	10	30	10*M8	76
HC76D700	700	624	776		3	9	18	12*M8	
HC76D900	900	824	976		3	9	18	14*M8	
HC76D1000	1000	924	1076		3	9	18	14*M8	
HC76D1100	1100	1024	1176		3	9	18	14*M8	
HC76D1200	1200	1124	1276		3	9	18	14*M8	
HC76D1267	1267	1191	1343		3	9	18	14*M8	
HC76D1300	1300	1224	1376		3	9	18	14*M8	
HC76D1400	1400	1324	1476		3	9	18	14*M8	
HC76D1500	1500	1424	1576		3	9	18	14*M8	
HC76D1560	1560	1484	1636		3	9	18	14*M8	

Note: The above are circular guideway of conventional standard size, and other sizes can be customized according to customer needs.

# GMP Series Products

## 76 Series-90°Circular guideway RB76

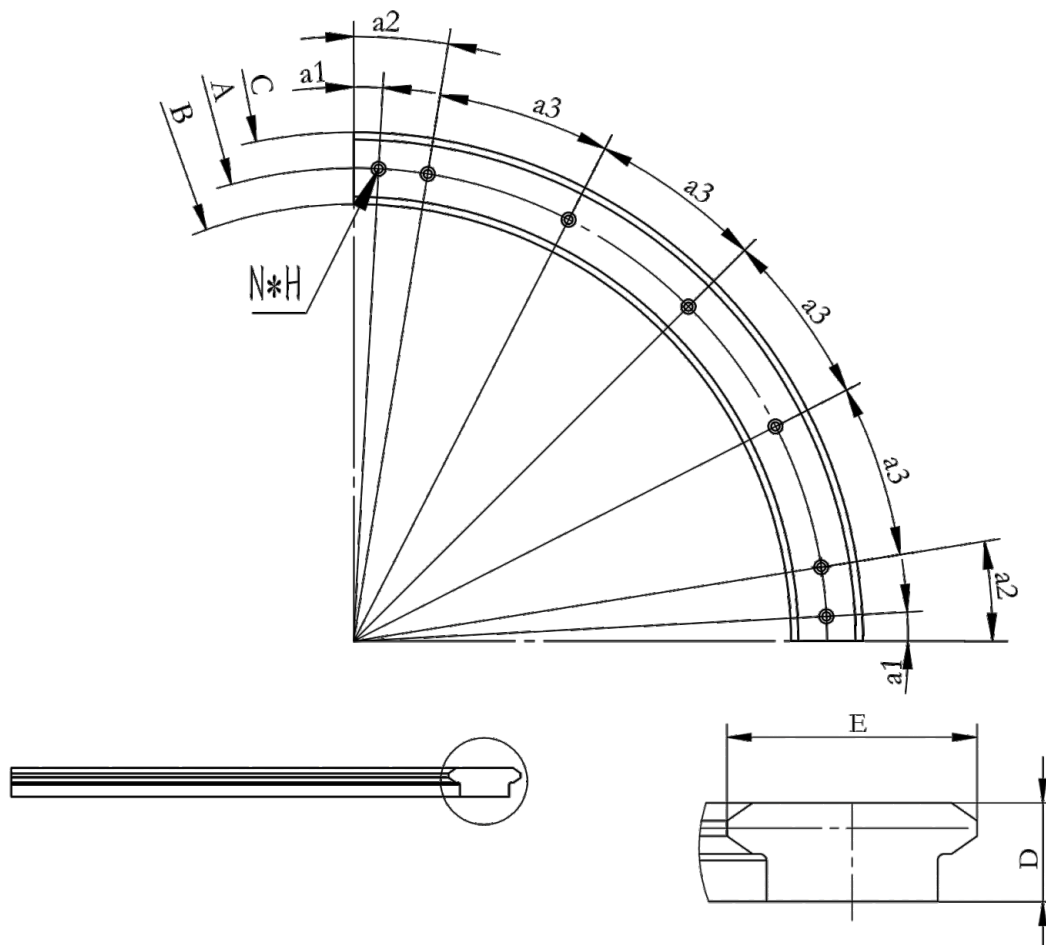

Model	Basic Size (mm)								
	$\phi A$	$\phi B$	$\phi C$	D	a1/Angle	a2/Angle	a3/Angle	N*H(Counterbore)	E
RB76D500	500	424	576	30	5	10	30	5*M8	76
RB76D700	700	624	776		3	9	18	6*M8	
RB76D900	900	824	976		3	9	18	7*M8	
RB76D1000	1000	924	1076		3	9	18	7*M8	
RB76D1100	1100	1024	1176		3	9	18	7*M8	
RB76D1200	1200	1124	1276		3	9	18	7*M8	
RB76D1267	1267	1191	1343		3	9	18	7*M8	
RB76D1300	1300	1224	1376		3	9	18	7*M8	
RB76D1400	1400	1324	1476		3	9	18	7*M8	
RB76D1500	1500	1424	1576		3	9	18	7*M8	
RB76D1560	1560	1484	1636		3	9	18	7*M8	

Note: The above are circular guideway of conventional standard size, and other sizes can be customized according to customer needs.

# GMP Series Products

## 76 Series- Linear guideway SR76-L2000-SS76

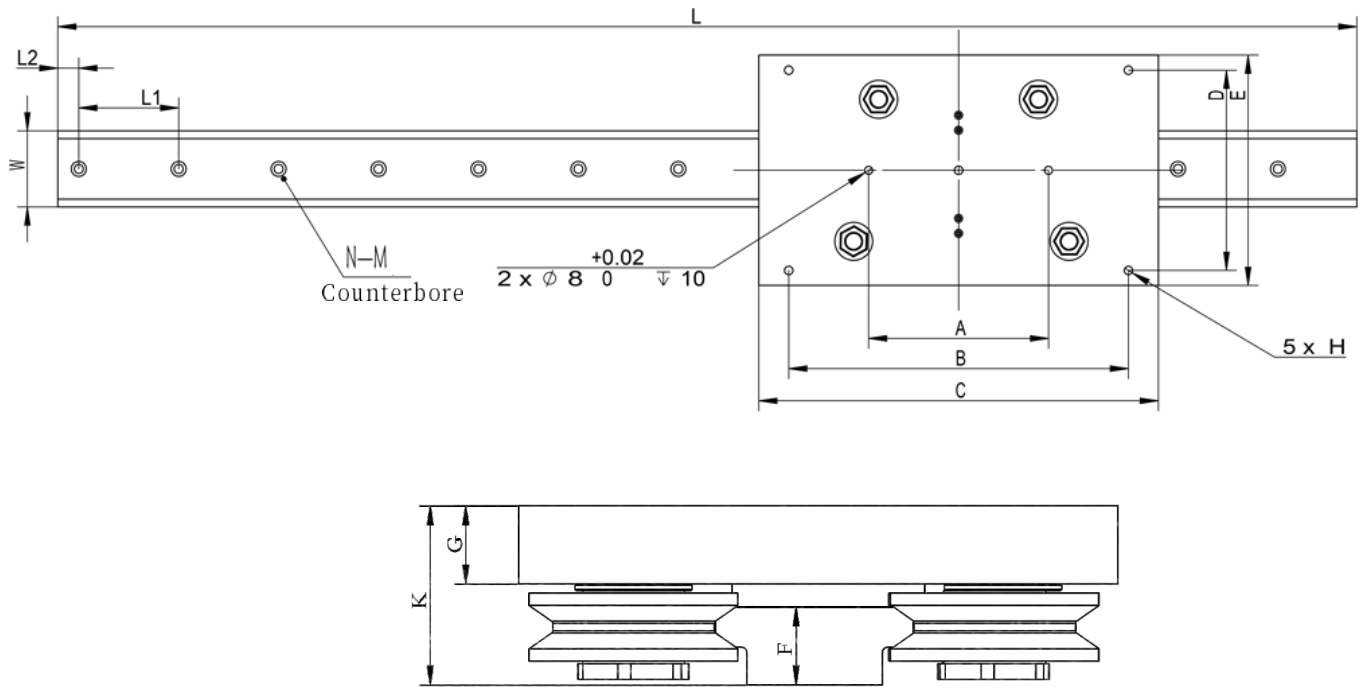

Series	Model	Basic Size (mm)													
		L	L1	L2	W	N-M Counterbore	A	B	C	D	E	F	G	K	5×H
GMP	SR76L2000SS76	≤2000	100	≤92	76	M8	180	300	400	200	230	30	30	68.7	M10

Note:

The above parameters are the dimensions of our single standard linear guideway, and the length can be cut and spliced according to the requirements.

Where N is the installation hole of the oil box used for lubrication and cleaning, one group for every 10 slide seats.

If  $L2 \geq 30$ mm, an additional mounting countersunk hole is added to the end.

The customized length of a single Linear guideway is:

$$L = L2 \times 2 + (n-1) \times 100 \text{ (mm)}$$

# GMP Series Products

## 76 Series- shaped guideway

### Oval guideway

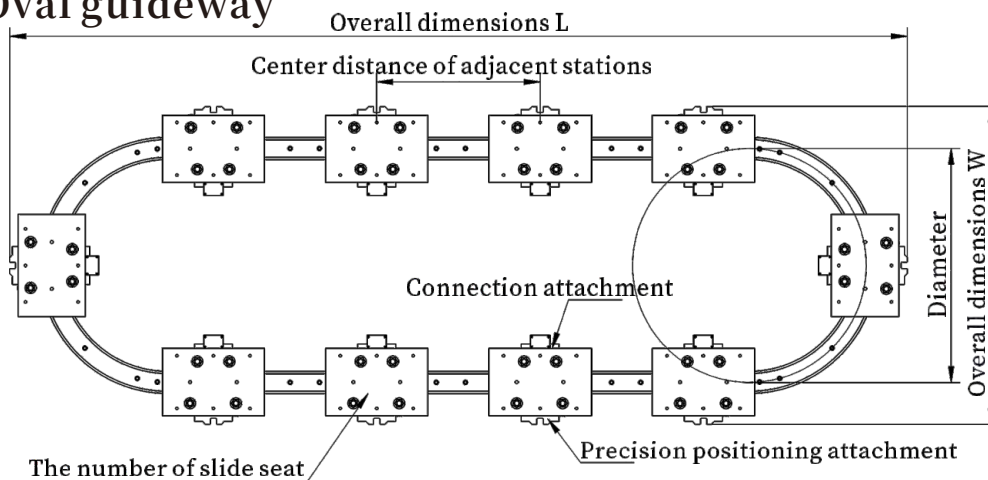

#### Main part

- ◆ Linear guideway
- ◆ 180°Circular guideway
- ◆ Slide seat

\*Non-standard customization, the linear guideway part can be cut or spliced according to needs; The 180°circular guideway size can refer to HC76 series; The number of slide seat is usually an even number.

### Rectangular guideway

#### Main part

- ◆ Linear guideway
- ◆ 90°Circular guideway
- ◆ Slide seat

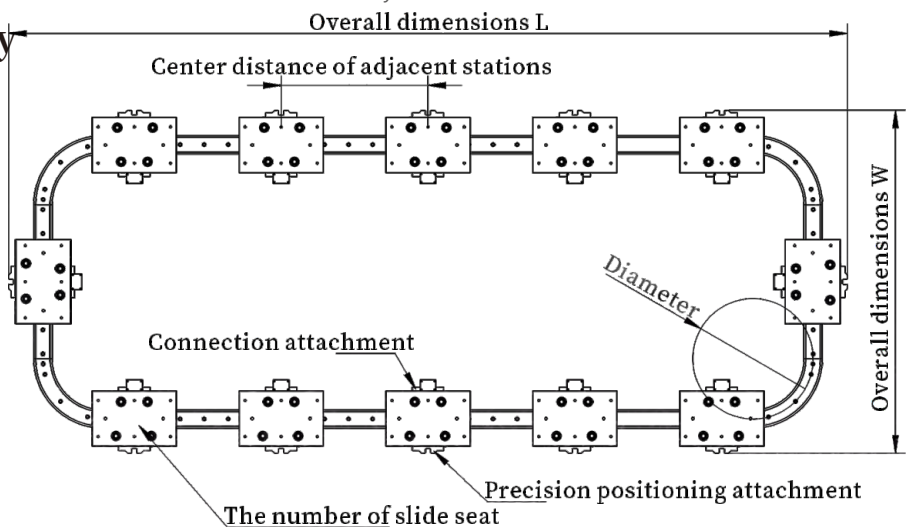

\*Non-standard customization, the linear guideway part can be cut or spliced according to needs; The 90°circular guideway size can refer to HC76 series; The number of slide seat is usually an even number.

### Other shapes guideway

#### Main part

- ◆ Linear guideway
- ◆ Circular guideway
- ◆ Slide seat

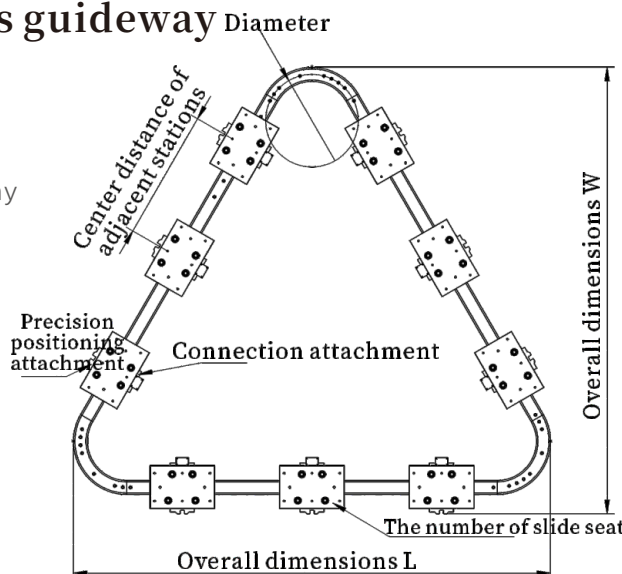

\*Non-standard customization, the linear guideway part can be cut or spliced according to needs; The 180°circular guideway size can refer to HC76 series;

\*Precision positioning attachment and Connection attachment are optional parts.

# GMP Series Products

## 25 Series- Gear guideway

Gear guideway, the combination of rack and guideway is very lightweight and space-saving. Run with a geared slide seat to independently control the power of a single slide seat, It has stable operation, low noise, high positioning accuracy, easy installation, suitable for more application scenarios.

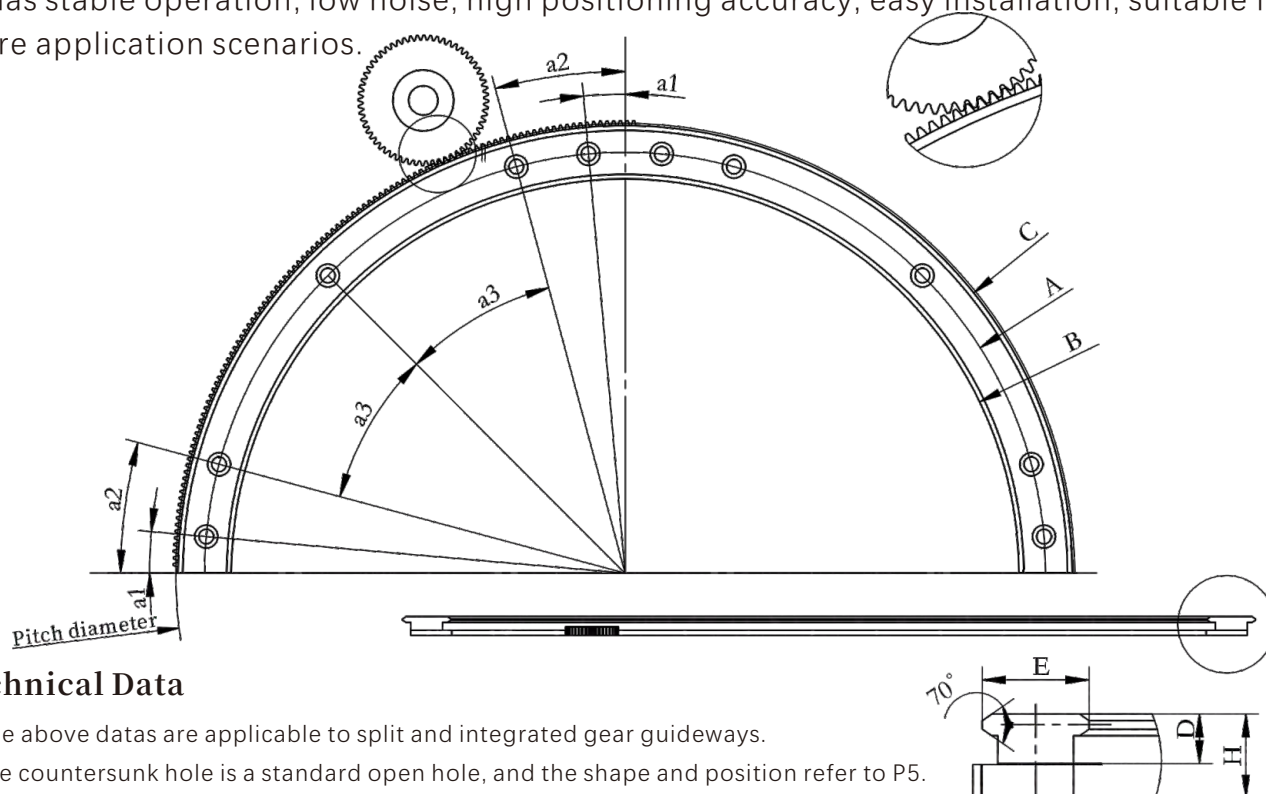

### Technical Data

- The above datas are applicable to split and integrated gear guideways.
- The countersunk hole is a standard open hole, and the shape and position refer to P5.

Model	Basic Size (mm)				The module of the gear	Technical Data			
	Diameter	D	H	E		Pitch diameter	Load-bearing(kg)	Velocity(mm/s)	Repeated positioning accuracy(mm)
TO25 L200	200	16	24-28	25.4	1	It is calculated according to the dynamic position, modulus, and number of teeth	15	200	±0.2
To25 L255	255								
To25 L300	300								
To25 L351	351								
To25 L400	400								
To25 L468	468								
To25 L500	500								
To25 L600	600								
To25 L700	700								
To25 L800	800								
To25 L900	900								
To25 L1000	1000								

\*The module of the gear can be customized, and the teeth of the gear can also be designed into internal teeth or external teeth according to the needs, please contact us for specific needs.

# GMP Series Products

## 44 Series- Gear guideway

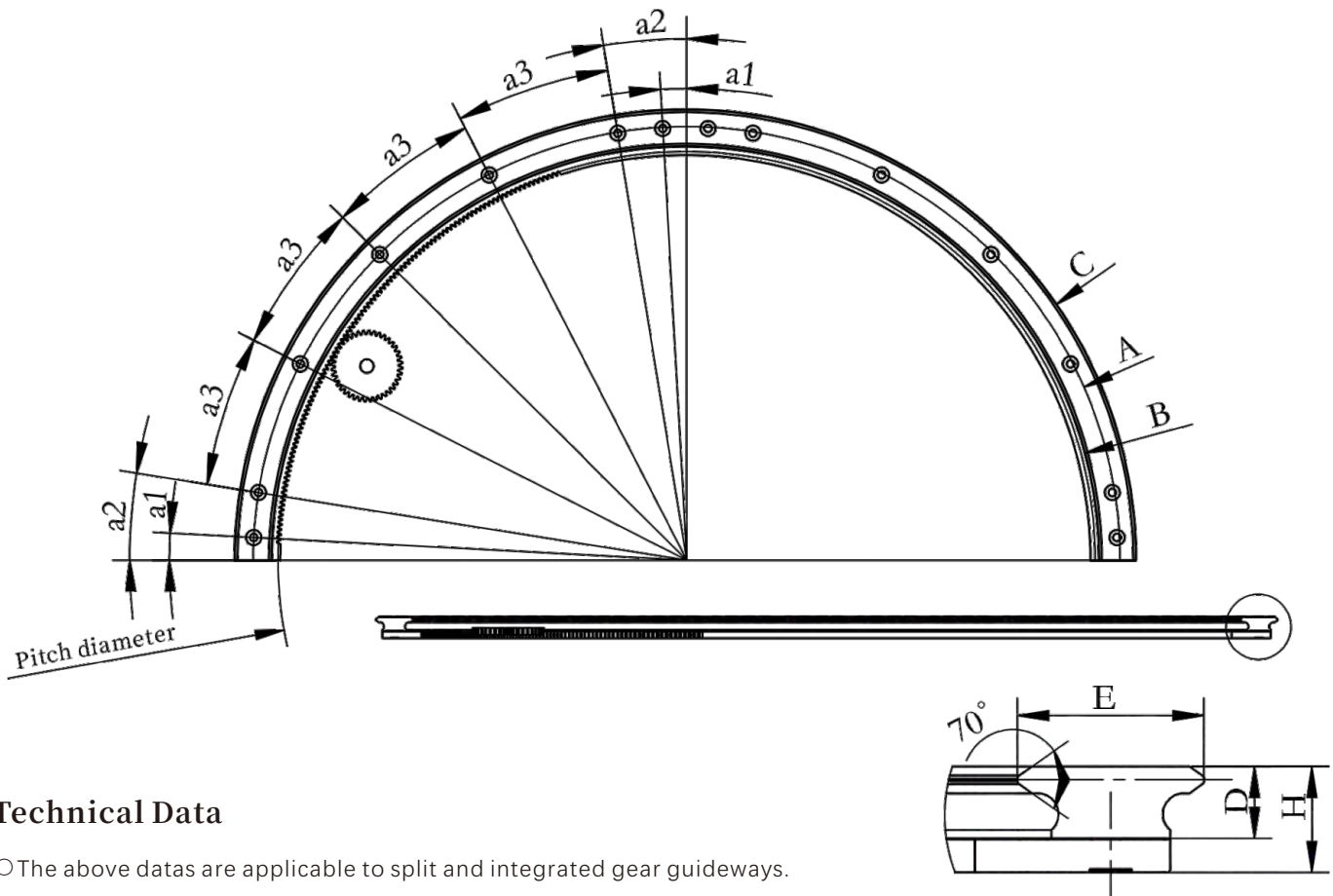

### Technical Data

- The above datas are applicable to split and integrated gear guideways.
- The countersunk hole is a standard open hole, and the shape and position refer to P10.

Model	Basic Size (mm)				The module of the gear	Technical Data			
	Diameter	D	H	E		Pitch diameter	Load-bearing(kg)	Velocity(mm/s)	Repeated positioning accuracy(mm)
TO44D468	468	18	30-34	44	1	It is calculated according to the dynamic position, modulus, and number of teeth	35	200	±0.2
TO44D612	612								
TO44D800	800								
TO44D1000	1000								

\*The module of the gear can be customized, and the teeth of the gear can also be designed into internal teeth or external teeth according to the needs, please contact us for specific needs.

# GMP Series Products

## 76 Series- Gear guideway

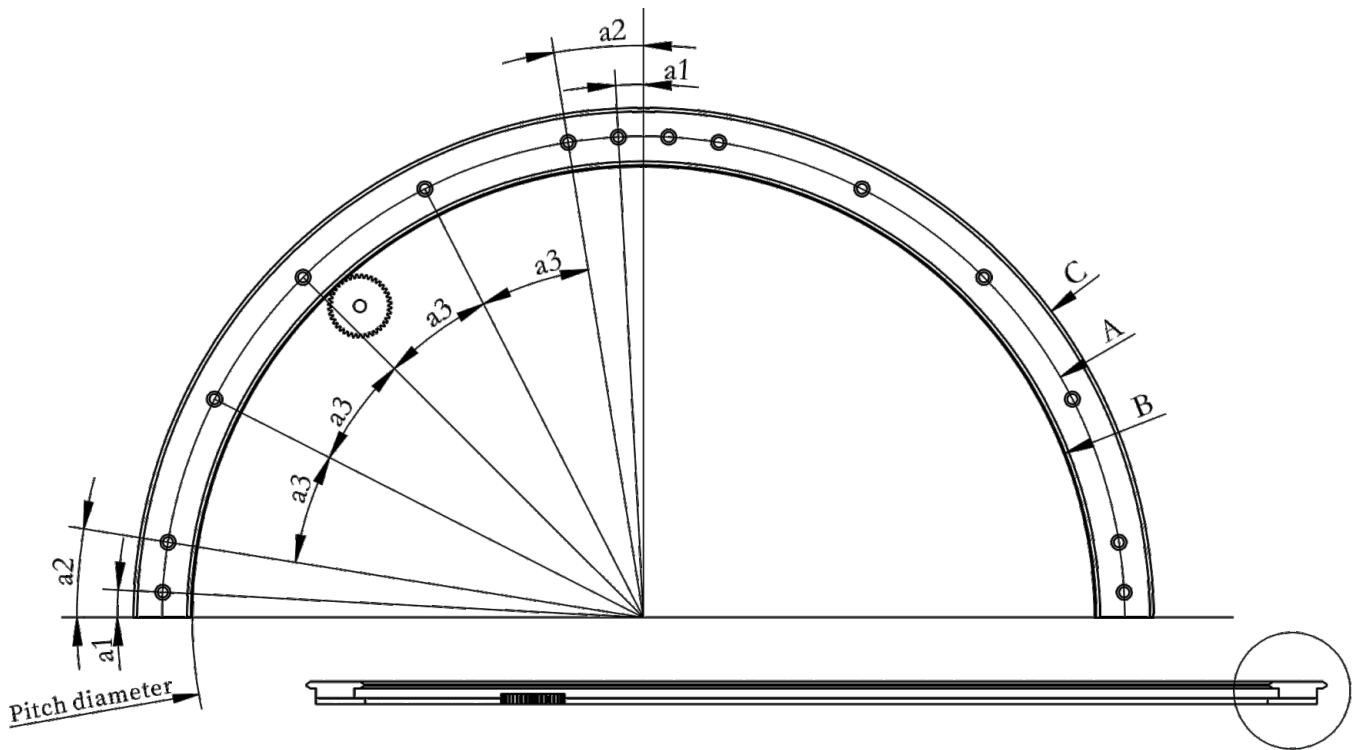

### Technical Data

- The above datas are applicable to split and integrated gear guideways.
- The countersunk hole is a standard open hole, and the shape and position refer to P5.

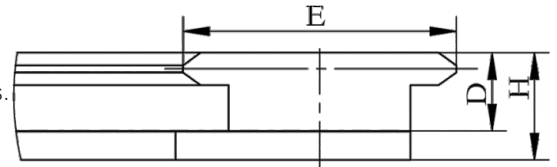

Model	Basic Size (mm)				The module of the gear	Technical Data			
	Diameter	D	H	E		Pitch diameter	Load-bearing(kg)	Velocity(mm/s)	Repeated positioning accuracy(mm)
RB76D500	500	30	45-50	76	2	It is calculated according to the dynamic position, modulus, and number of teeth	70	100	±0.2
RB76D700	700								
RB76D900	900								
RB76D1000	1000								
RB76D1100	1100								
RB76D1200	1200								
RB76D1267	1267								
RB76D1300	1300								
RB76D1400	1400								
RB76D1500	1500								
RB76D1560	1560								

\*Note: The module of the gear can be customized, and the teeth of the gear can also be designed into internal teeth or external teeth according to the needs, please contact us for specific needs.



# GMP Series Products

## Application Cases Of GMP Series Products

GMP series products, can be used as parts of Precision loop line, can also be customized to use, suitable for more industries and application scenarios.



### GMP Series Products:

It can be used in medical testing, intelligent technology, aerospace technology, rail transit, warehousing and logistics, hardware casting, digital home appliances, pharmaceutical manufacturing, battery manufacturing and other mechanical automation production and manufacturing process.

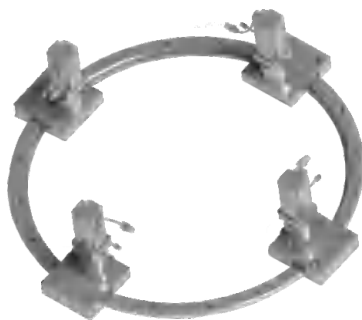





### **The Industry Pioneer in The Chinese Market**

Years of accumulation of technology and market, won the long-term cooperation and recognition of many domestic customers, in the domestic precision conveying industry, Zillion technology has always maintained a pioneering role.



### **The Expansion of Overseas Markets**

Markets in Southeast Asia, South Asia, the Middle East, West Asia, Europe, South America, and North America have gradually expanded, and Zillion technology's products have gradually served the global manufacturing industry.



### **Market Recognition in China, Hong Kong, Macao and Taiwan**

Our market in Hong Kong, Macao and Taiwan has been recognized, customers through the word of mouth initiative contact to buy, from Hong Kong, Macao and Taiwan more and more customers choose Zillion technology products.



### **International Transmission Brand**

Technology internationalization, market internationalization. Continuous innovation and precipitation of technology, continuous improvement of quality, to create high-quality international transmission brand.



## CONTACT US

Email: [zhenjikeji@zhenjikeji.com](mailto:zhenjikeji@zhenjikeji.com)

URL: [www.zhenjizdh.com](http://www.zhenjizdh.com)

TEL: 150 1600 6490 / 150 1600 8490

ADD: No. 2, South Huatai Road, Huinan  
High-tech Industrial Park, Huiao Avenue,  
Huizhou, Guangdong Province